

# Sander Operation

## Requirements for Student Use of the Shop Sanders

Before you can use the machinery, the following requirements must be met:

- 1) Sanding **Machine Shop Training** must have been completed.
- 2) **“Sign UP for a time“** in advance of when you need it, on the posted shop schedule.
- 3) **Respect blocked out course times and instruction time.** These times are posted on the shop schedule. Use of the shop will be reserved during these times.
- 4) **Avoid “walking in” at the last minute.** Shop personal have many daily duties. We always like to help, but common courtesy and a little planning on your part will go a long way toward smoother operations.

# Belt and Disk Sander

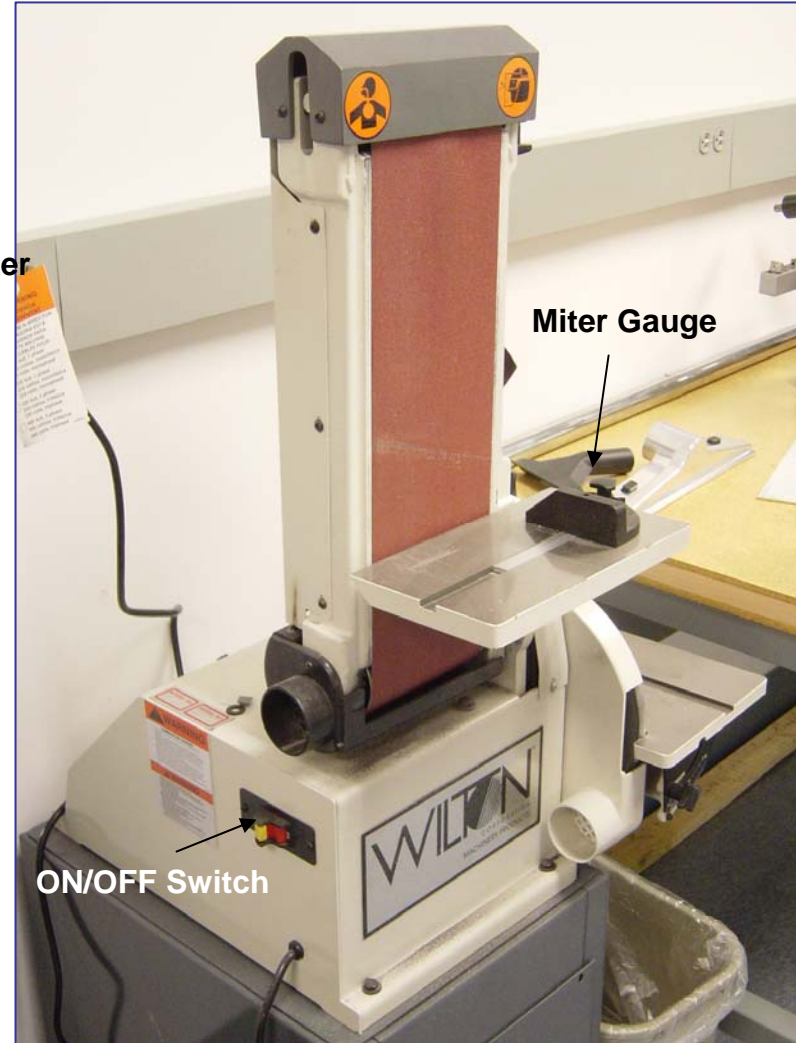
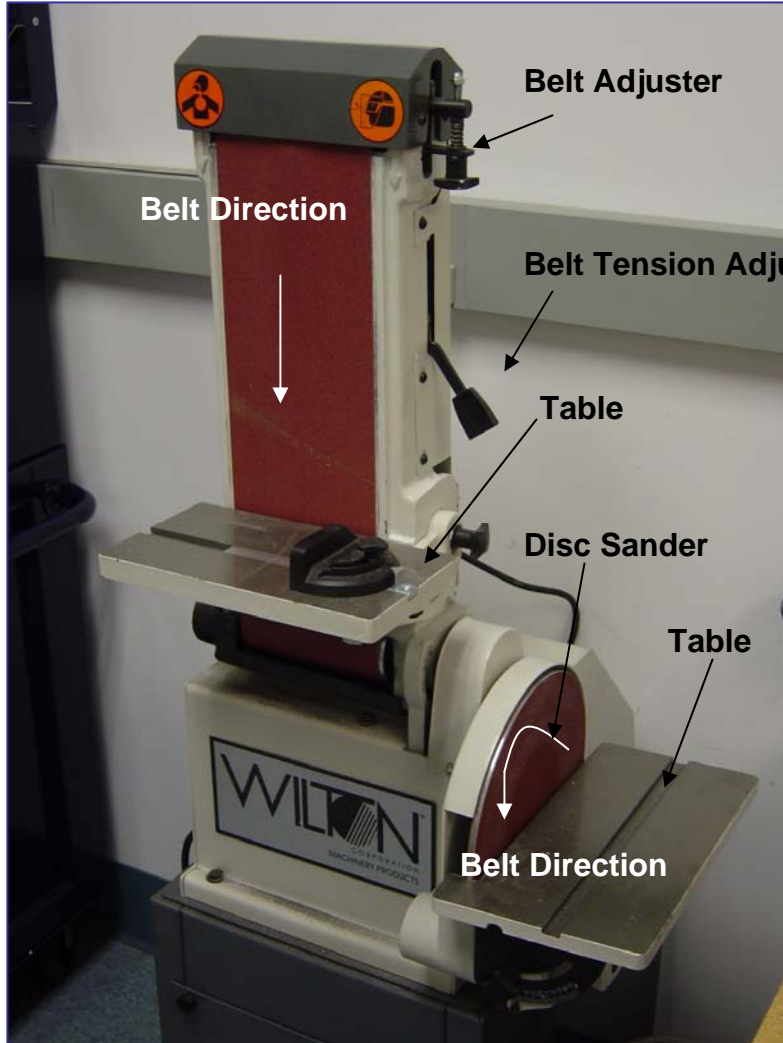

## Saw Leaves Rough Cut, Clean Up with Sander

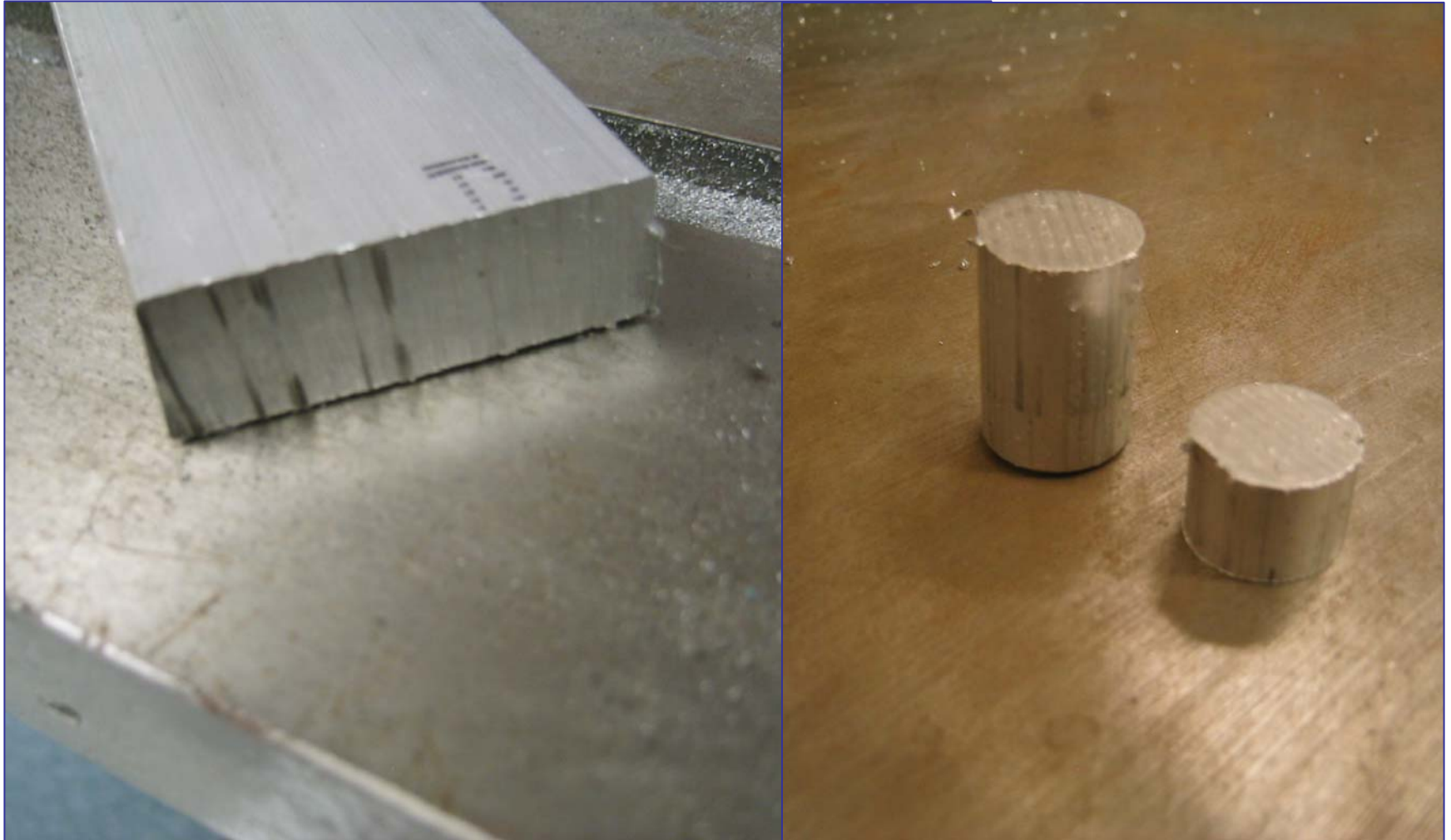

## Steady Part on Work Table



←Move Part from Side to Side as you Sand→



## ALWAYS Steady Part on Work Table !

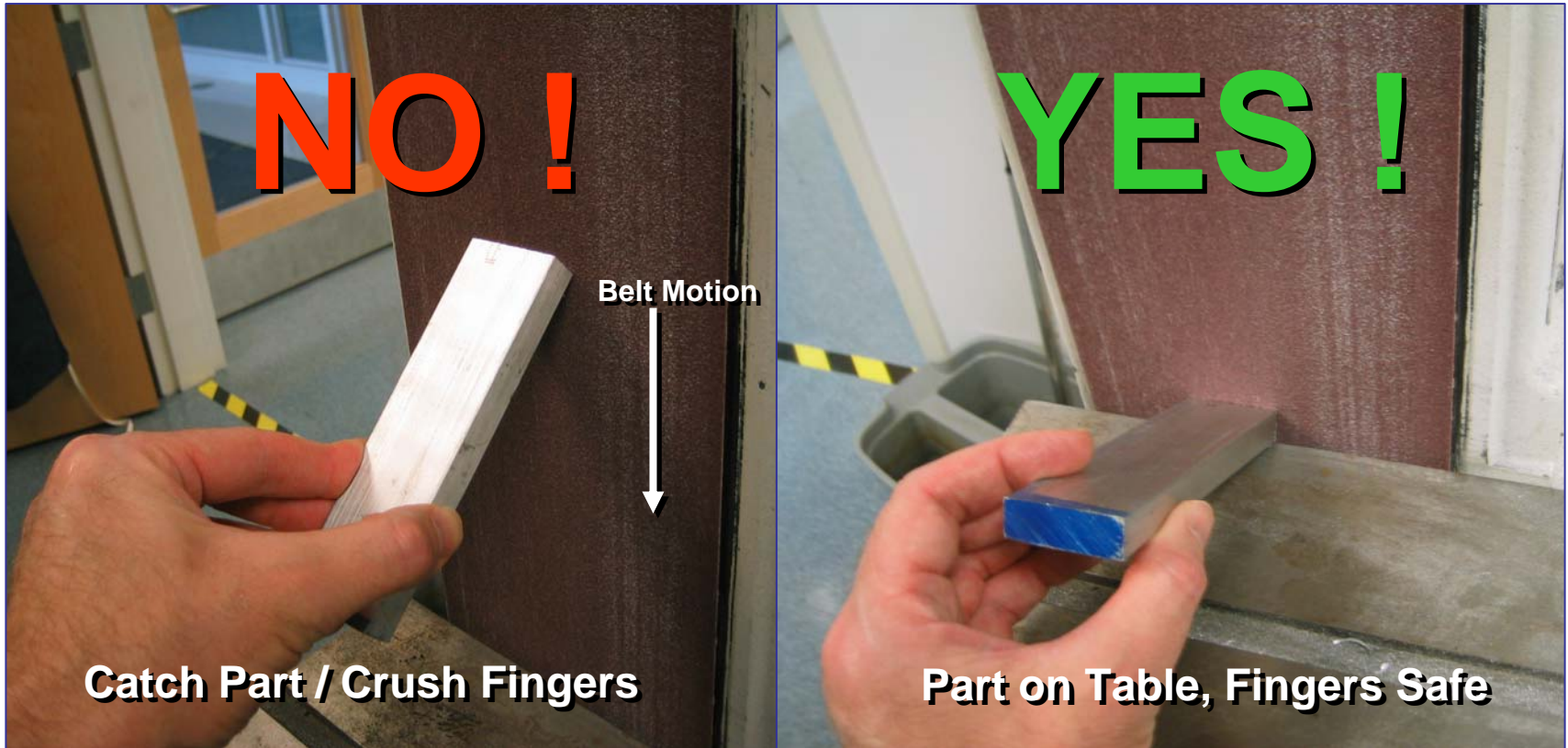

## ALWAYS Steady Part on Work Table !

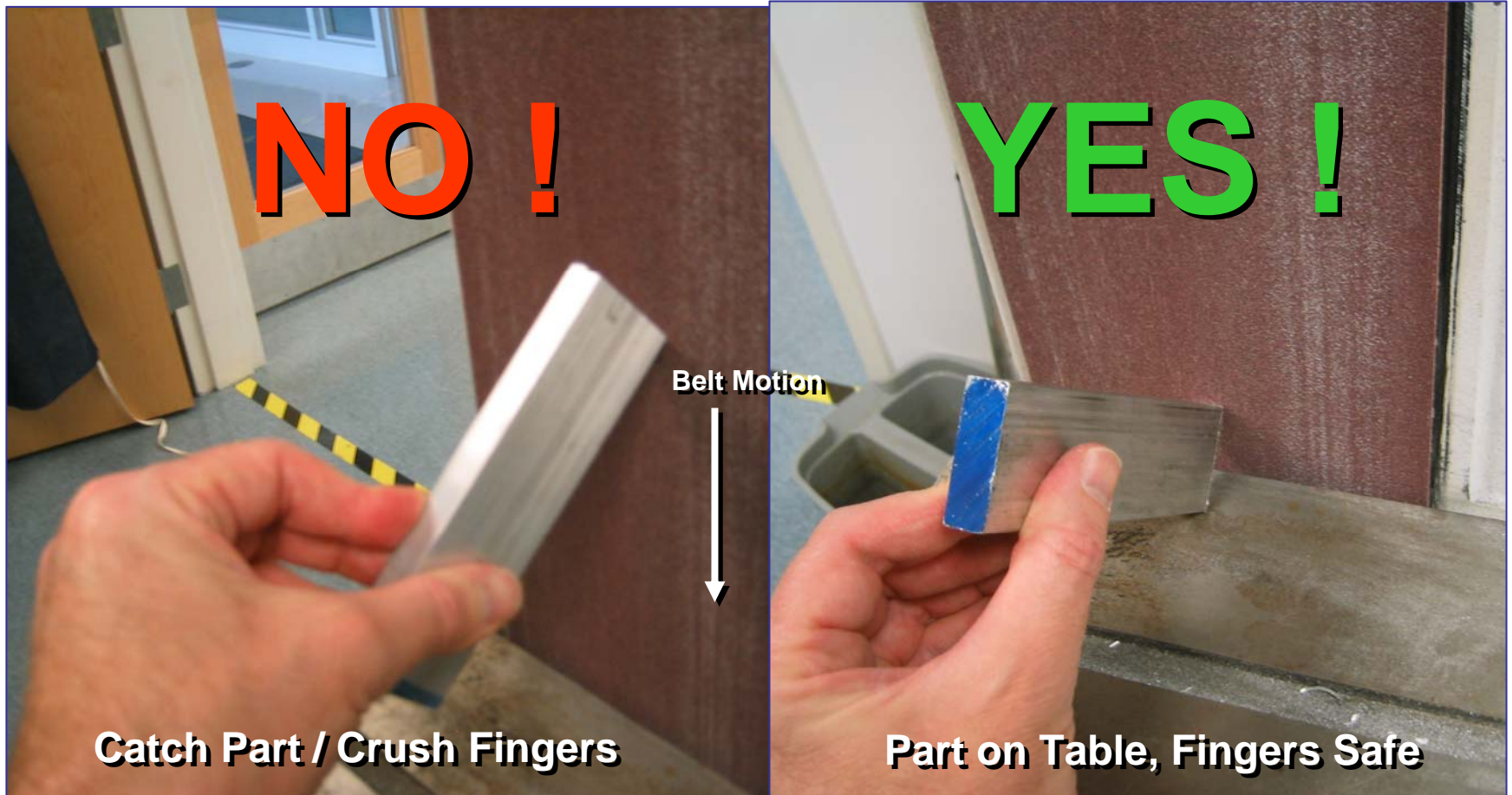



## ALWAYS Steady Part on Work Table !



## Belt / Disc Sander

*Remember: Only one person operates the machine*



### PURPOSE

- Debur, chamfer, radius, general shaping.

### DANGERS

- Keep hands and fingers clear from belt and disc.
- Make sure work is gripped tightly.
- Use side on disc sander that forces work to table.

### CLEAN UP

- Brush all dust off machine and sweep floor.
- Always leave machine clear of objects and clean.

### HOW TO OPERATE

- Metals and plastics ONLY in metal shop.
- Wood only in wood shop.
- Inspect belt for rips or holes, if so discontinue use.
- Use face shield for aggressive sanding.
- Stand clear when first turned on.
- Disc has variable cutting speed, slow at center, fast at periphery.
- Vise grips OK on small work.
- More shapes, more materials can be sanded vs. grinding.
- Adjust tables to be perpendicular or obtuse to sanding surface
- Quench work in water as needed.